

PARCO DI BACCU TINGHINU

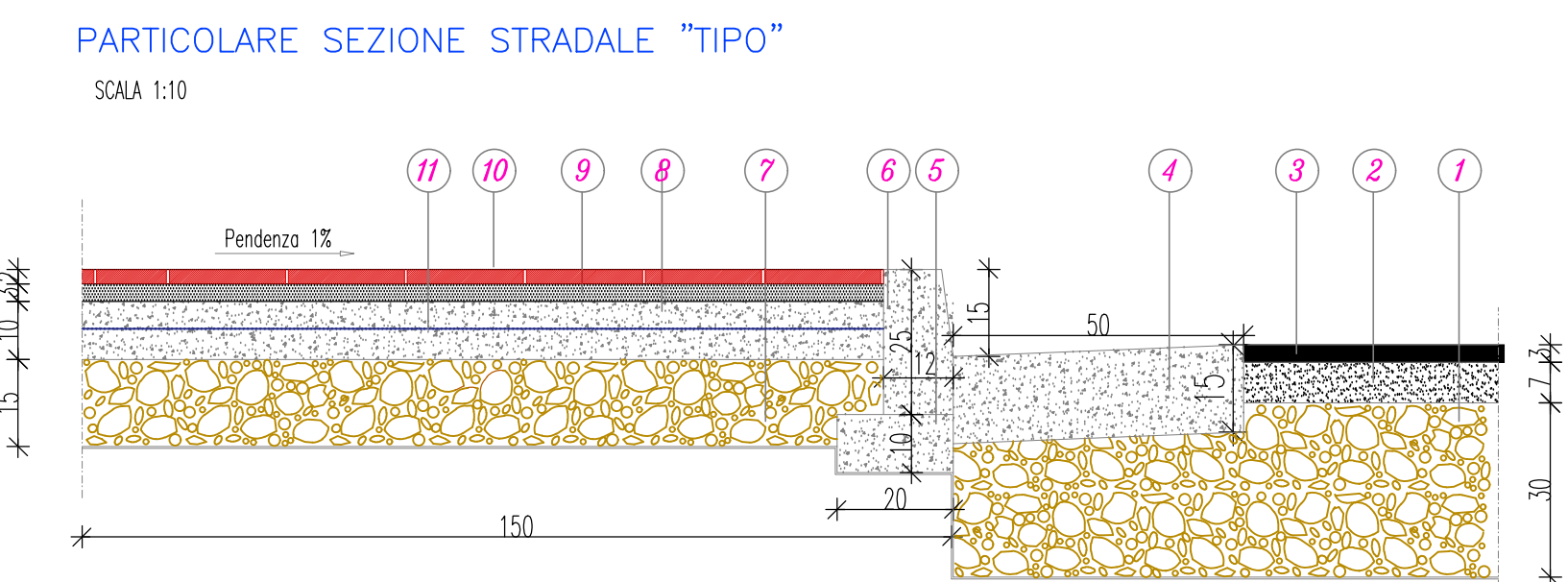

- LEGENDA**
- 1) TOUT-VENANT cm 30
 - 2) BINDER cm 7
 - 3) MANTO USURA cm 3
 - 4) CUNETTA CLS cm 50x15
 - 5) FONDAZIONE CLS cm 20x10
 - 6) CORDOLO CLS cm 12x25
 - 7) TOUT-VENANT cm 15
 - 8) MASSETTO CLS F'ck 15
 - 9) MALTA CEMENTIZIA
 - 10) PIASTRELLE IN CEMENTO cm 20x20
 - 11) RETE ELETTROSALDATA 20x20x5

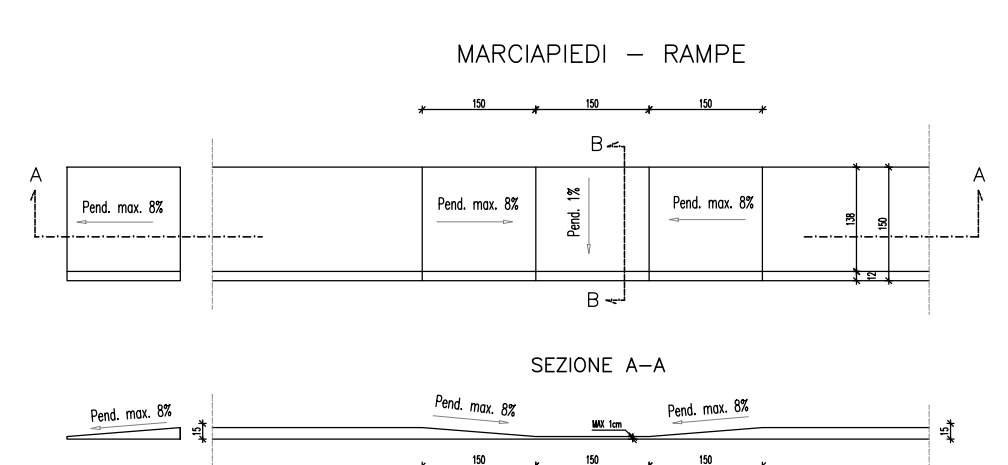
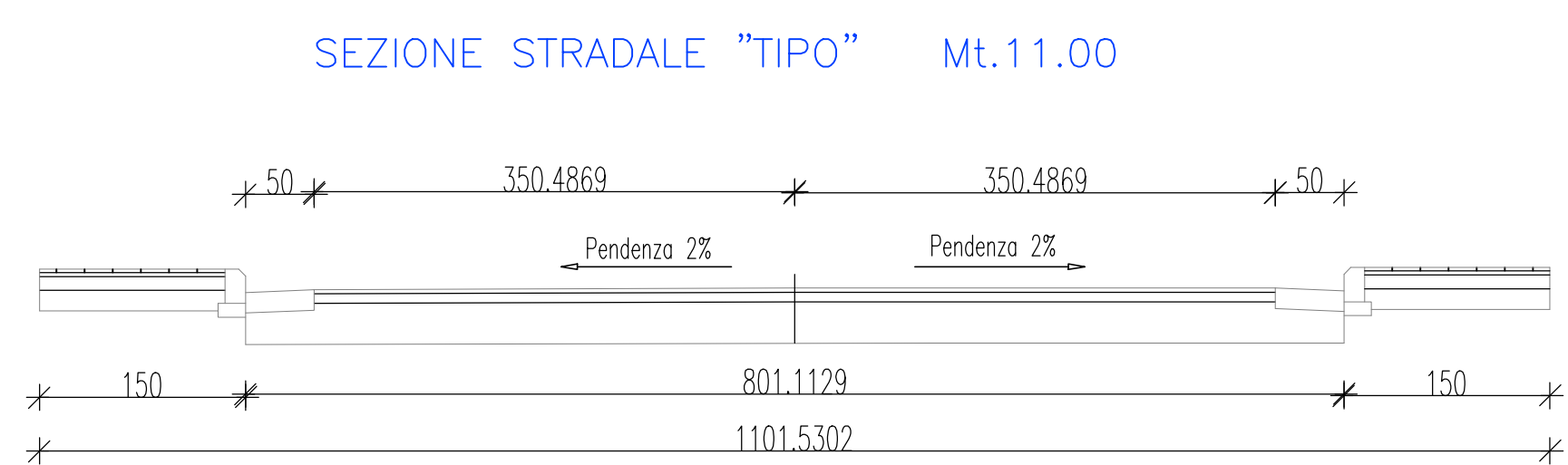
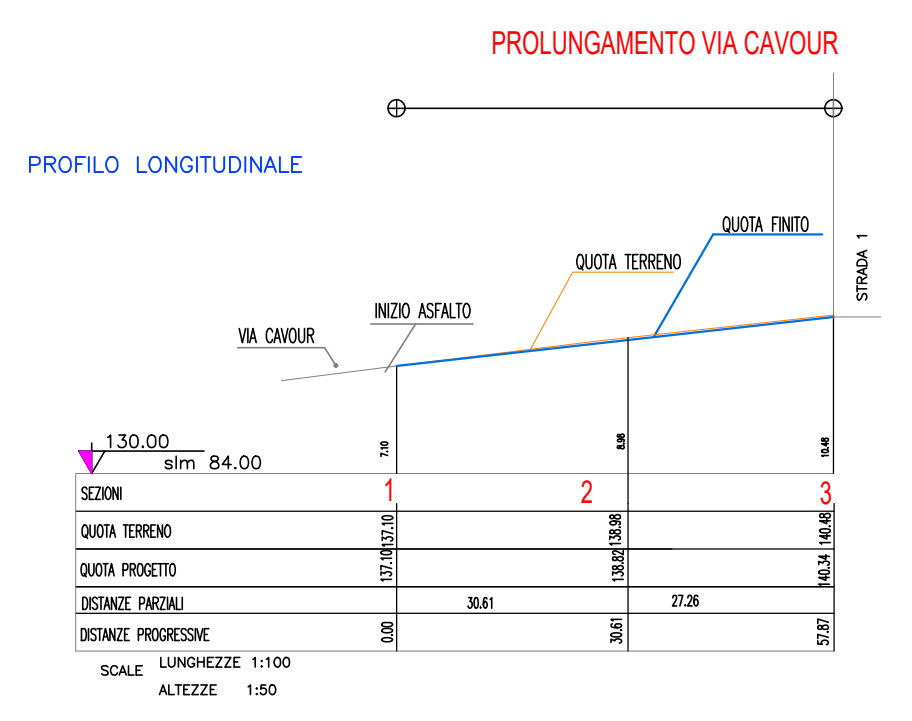
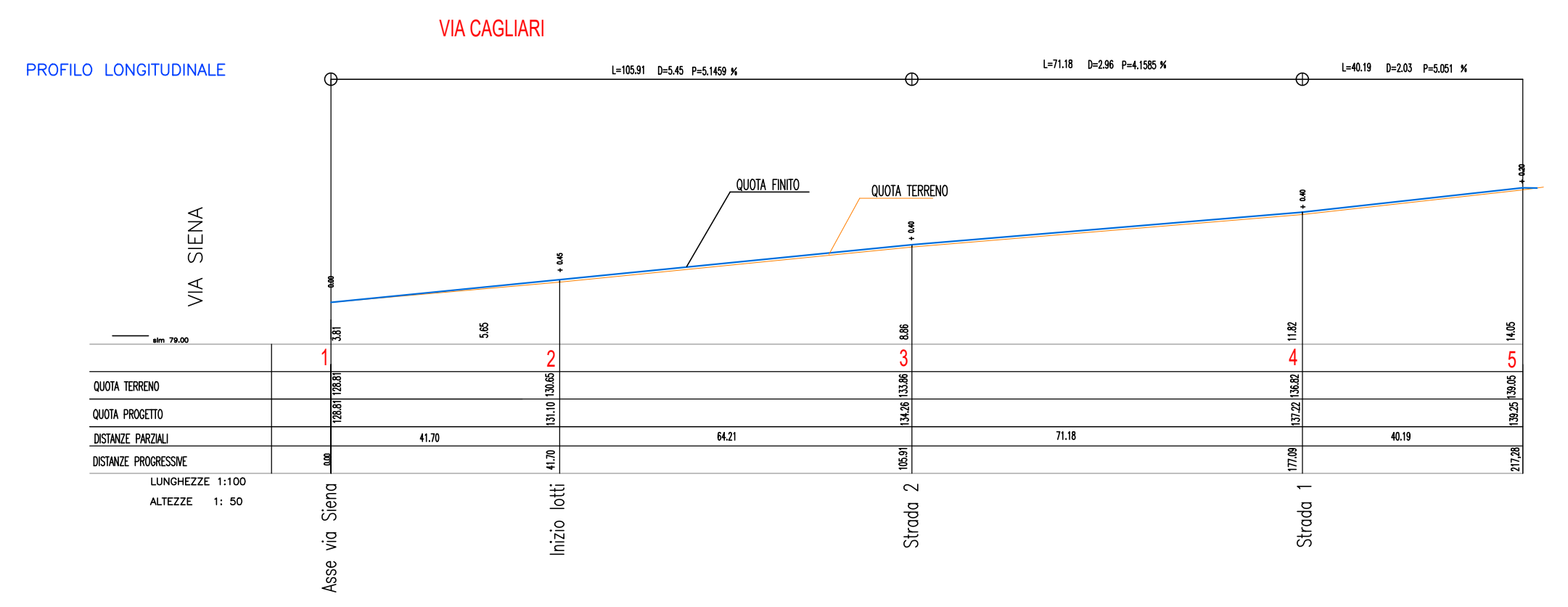
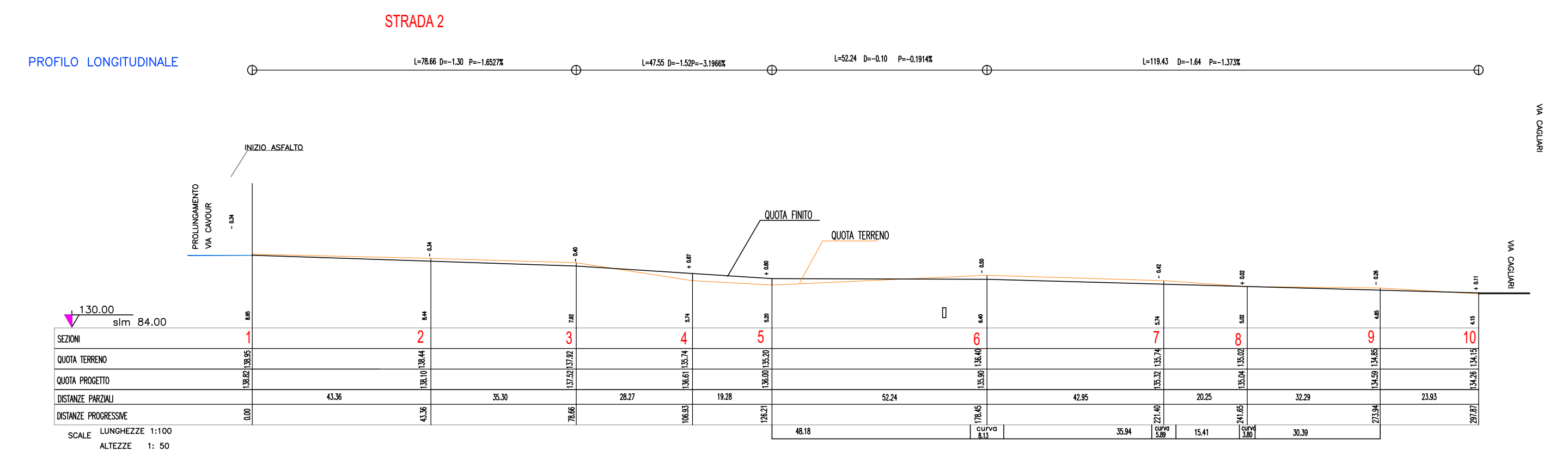
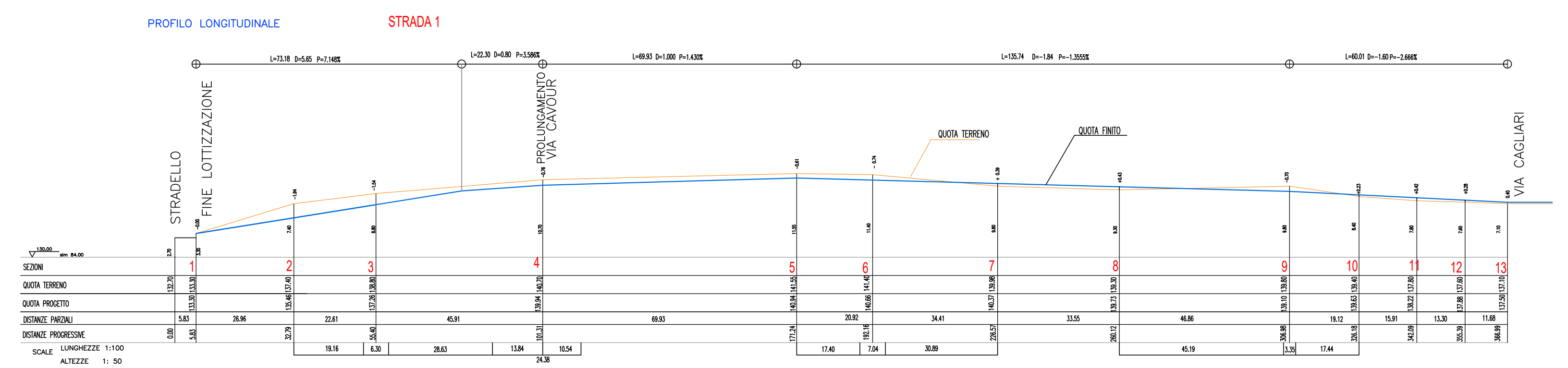
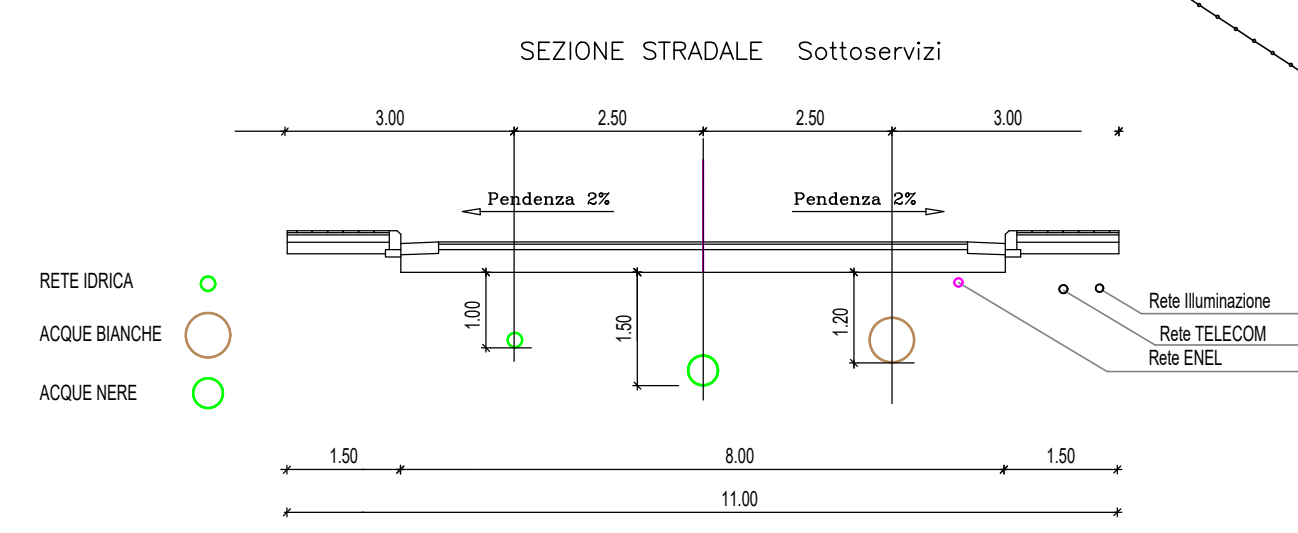

COMUNE di	CAPOTERRA	STUDIO ARCHITETTURA E TECNICA A&T VIA DIAZ N. 102 - CAPOTERRA Tel. 3381962375 VIA MANNI N. 94 - SEIARGIUS farigu@fastweb.it
PIANO DI LOTTIZZAZIONE "PARCO DI BACCU TINGHINU"	Progettisti Dott. Ing. Efisio Farigu Dott. Arch. Gianmarco Baire	
ESPANSIONE RESIDENZIALE ZONA CS-4.1	Comitenti BAIRE Adelina-BAIRE Gianluca-BAIRE Mario-BAIRE Matteo BAIRE Vittorina-CABONI Albina-LAI Giancarlo-LAI Luciano PINNA Regina-FARIGU Efisio-SEGURO Paola	
PROGETTO DEFINITIVO	TAVOLA N. 10	DATA MARZO 2022
VIABILITA' SEZIONI STRADALI	SCALA GRAFICA: 1:500	AGGIORN. SETTEMBRE 2025
Localita'	BACCU TINGHINU	